



Name: 12" Rotary Wellpoint Pump

Model: 12R

The Thompson Rotary Wellpoint Pump is the original rotary wellpoint pump trusted by contractors worldwide for more than 40 years. The state-of-the-art 12R is specifically designed and engineered for wellpoint and sock dewatering with high air handling, large water volume and high vacuum capability.



Photo shown may not be exact model.

Consult factory for other versions & options including site trailers, sound attenuation, etc.

Pump End Materials	
Type	Positive displacement, low-pulsation, self-priming, rotary lobe.
Rotor	Four-lobe, single piece design with carbon steel shaft and welded carbon steel fins with polyurethane coating.
Rotor Housing	Rugged, heavy-duty cast Aluminum.
Mechanical Seal	Oil lubricated with bronze rotating and steel stationary faces. Single inside mounted, non-pusher type with self-adjusting elastomeric bellows.
Suction Tank	A36 steel with permanent solids screen, 1-1/2" drain port, adjustable vacuum breaker valve and vacuum gauge for system diagnostics.
Discharge Tank	A36 steel with canvas reinforced neoprene weighted flapper style check valve; built-in reservoir with pressure relief and 1-1/2" drain port.
Wear Plate	Replaceable, 304 stainless steel.
Bearings	Heavy-duty, oil bath-pressure lubricated, cylindrical roller type.
Bearing Housing	Heavy-duty cast Aluminum.

Technical Specifications			
Suction Size	12 in (30.48 cm)	Approximate Dry Weight	5,510 lbs (2,499.29 kg)
Discharge Size	12 in (30.48 cm)	Maximum Operating Speed	2,200 rpm
Maximum Solids Handling	Clear Water Only	Displacement Volume	400 cfm
Maximum Operating Temperature	200° F (93.33° C)	Maximum Operating Pressure	51.9 psi (358.17 kPa)

Fuel Tank Options*		Deutz	
Modular (M)		127 Gal	32 Hours
Double-Wall (D)		94 Gal	24 Hours
Modular Large Capacity (X)		200 Gal	51 Hours
Double-Wall Large Capacity (Z)		150 Gal	38 Hours

*Contact factory for fuel tank sizes not listed above.

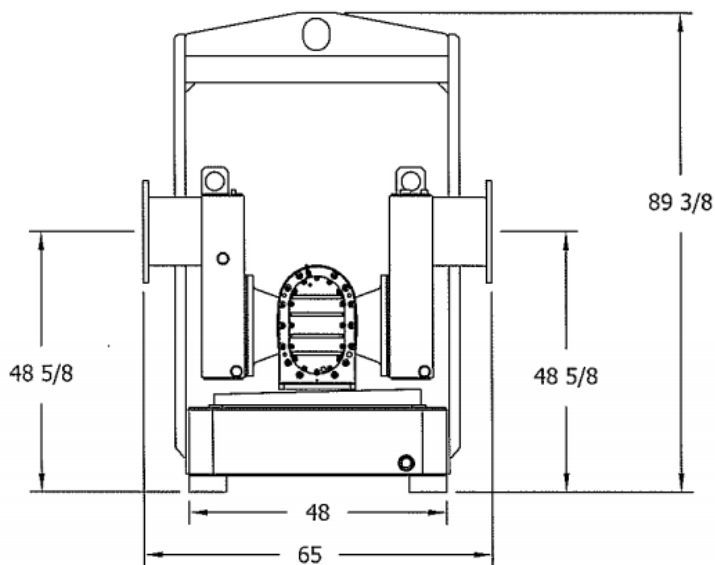
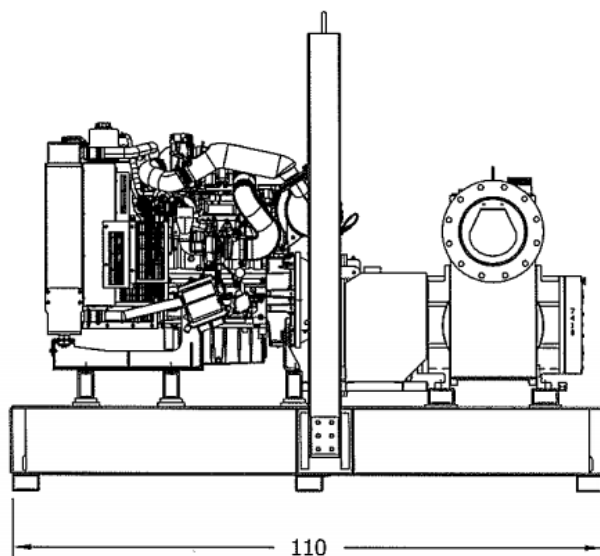
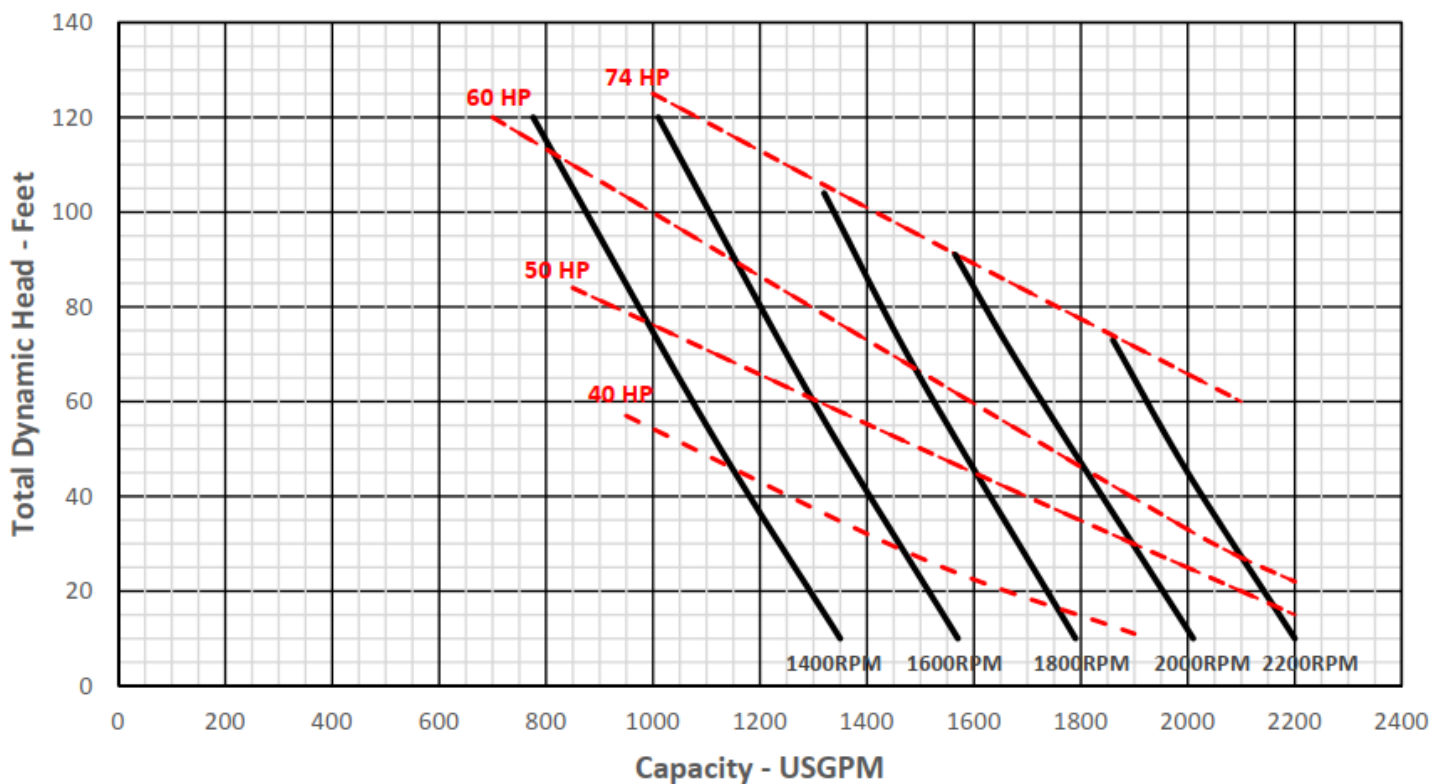

Deutz TD3.6L4—74 hp @ 2,400 rpm

Typical Operating Speed	2,200 rpm	Pump Speed	Fuel Economy	Run
Maximum Head	120 ft (36.58 m)	2,200 rpm	0.382 lb/hp-hr	31 hrs
Maximum Flow Capacity	2,200 gpm (499.4 m ³ /hr)	2,000 rpm	0.371 lb/hp-hr	32 hrs
Maximum Fuel Consumption	4.08 gph (15.44 L/hr)	1,800 rpm	0.364 lb-hp-hr	32 hrs

*Engine run times calculated based on a 127 gallon fuel tank.

Specifications and illustrations are subject to revision without notice and without incurring any obligation for previous or subsequent equipment sold. Thompson Pump (ISO 9001:2015) makes no representation regarding the completeness or accuracy of this information and is not liable for any direct or indirect damages arising from or relating to this information or its use. Capacity & Head are shown for comparative purposes. Consult Thompson factory for exact capabilities.